

# BETHEL TOWNSHIP MIAMI COUNTY, OHIO KEY MAP

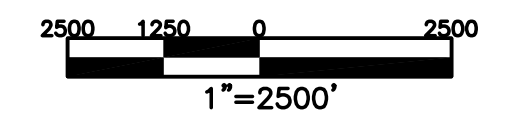

ABBREVIATION LEGEND	
	= U.S. ROAD
	= STATE ROAD
	= COUNTY ROAD
T-183	= TOWNSHIP ROAD
	= INCORPORATED AREAS

- SECTION 5**  
 1. HEILMAN DR.  
 2. WESTLAND DR.  
 3. EASTLAND DR.  
 4. OVERLOOK DR.
- SECTION 7**  
 1. WEST HASKETT LANE  
 2. EAST HASKETT LANE
- SECTION 10**  
 1. BETHELVILLE DRIVE  
 2. BEAUTONIA AVE.
- SECTION 14**  
 1. WONDER WAY
- SECTION 21**  
 1. WINTERHILL CT.  
 2. WINDHAM RD.  
 3. NEWBURY RD.
- SECTION 25**  
 1. JULIE CT.  
 2. GIBSON DR.  
 3. LISA DRIVE  
 4. DINSMORE DR.  
 5. SHROYER DR.

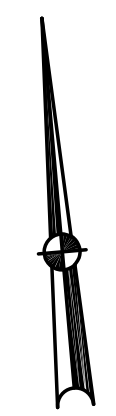
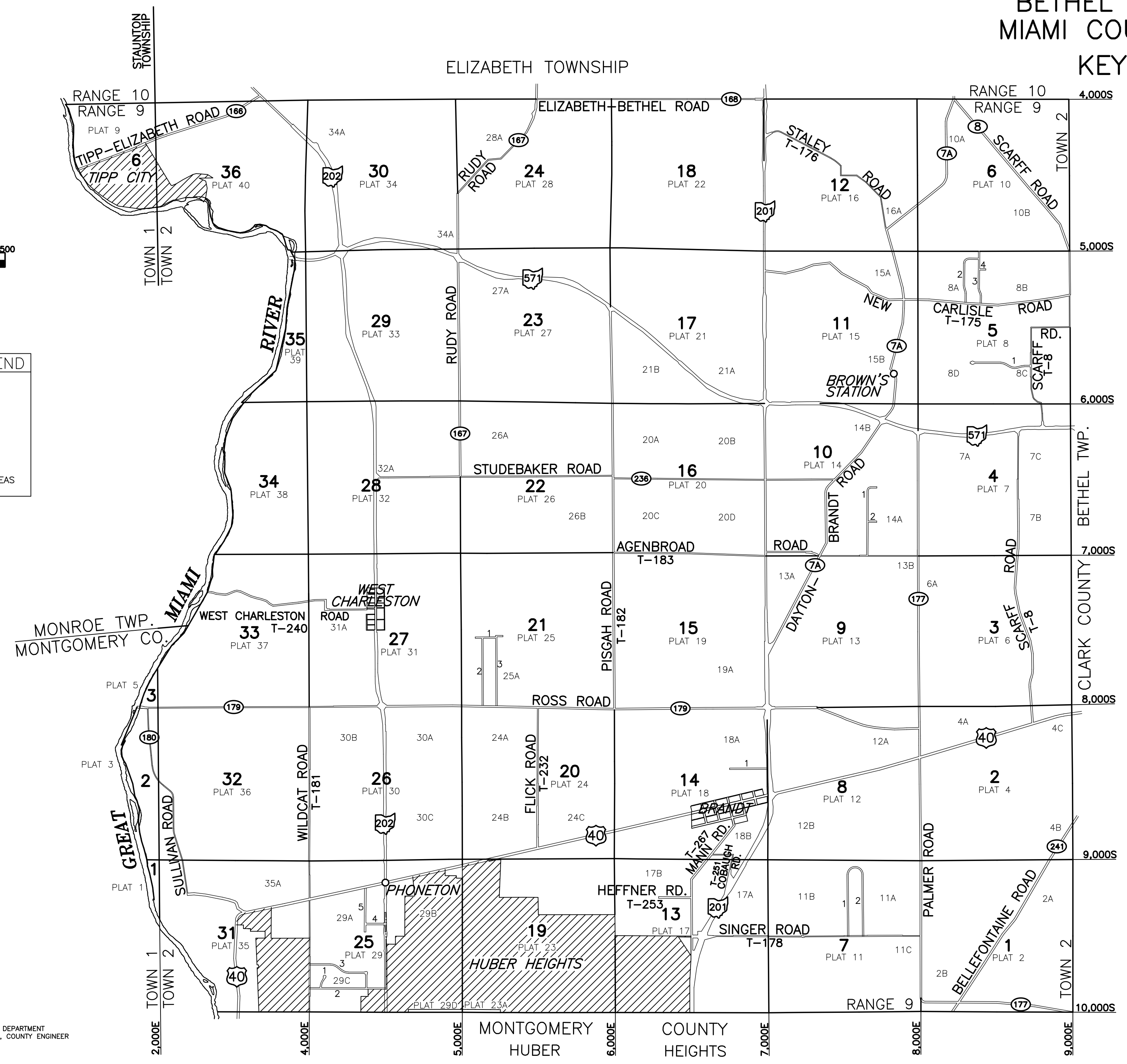

PREPARED BY: MIAMI COUNTY ENGINEER'S MAP DEPARTMENT  
 PAUL P. HUELSKAMP, P.E., P.S., COUNTY ENGINEER  
 DATE: JUNE 9, 2016 MB  
 REVISED: 6/23/2022 APALMER